

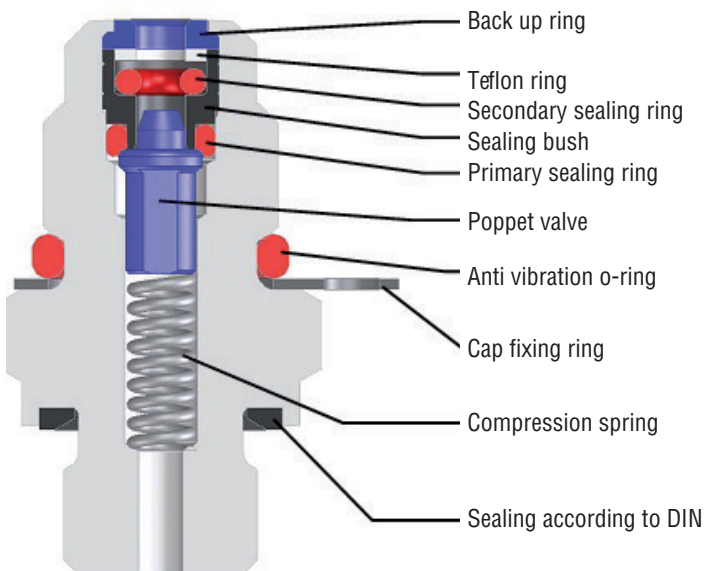

INTERNATIONAL ADAPTER & FITTING SOLUTIONS



MINIMESS®
1620 TEST POINTS



4005ES

MINIMESS® 1620 x Male BSPP ES
Sealed

4005ES-16X2.0-02

4005ES-16X2.0-04

4005ES-16X2.0-06

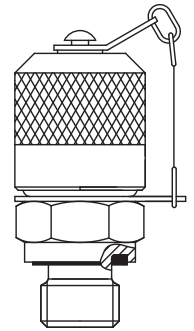

4006

MINIMESS® 1620 x Male ORB

4006-16X2.0-04

4006-16X2.0-06

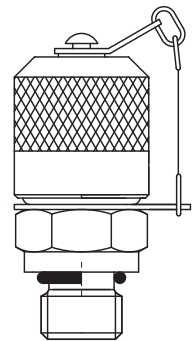

4007

MINIMESS® 1620 x Male NPT

4007-16X2.0-02

4007-16X2.0-04

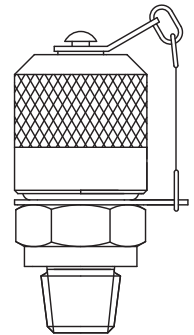

4011

MINIMESS® 1620 x Male BSPT

4011-16X2.0-02

4011-16X2.0-04

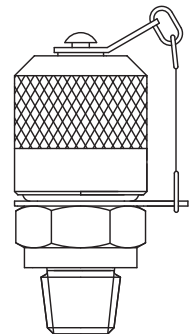

4020

MINIMESS® 1620 x Female JIC

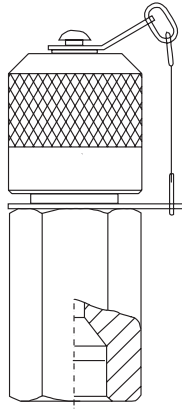

4020-16X2.0-04

4020-16X2.0-05

4020-16X2.0-06

4020-16X2.0-08

4025

Female MINIMESS® 1620 x
Female BSP

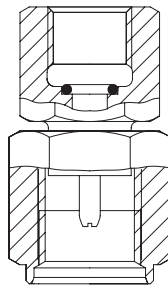

4025-16X2.0-04

4025-16X2.0-08

4040FBSP

MINIMESS® 1620 x Female
BSP Bulkhead

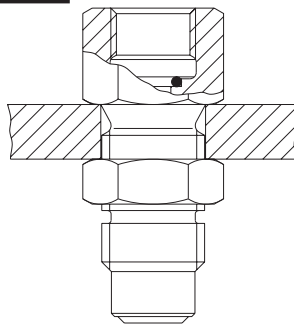

4040FBSP-04-16X2.0

4040FBSP-08-16X2.0

4040FNPT

MINIMESS® 1620 x Female
NPT Bulkhead

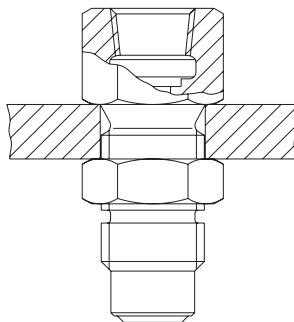

4040FNPT-04-16X2.0

4068ES

MINIMESS® 1620 x Male Metric ES
Sealed

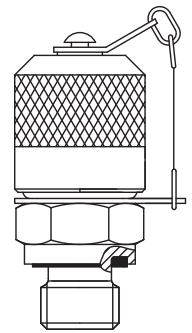

4068ES-16X2.0-12

4068ES-16X2.0-14

4068ES-16X2.0-16

4068H

MINIMESS® 1620 x Male Metric
Hydrotechnik STD N901-01-14
with Oring

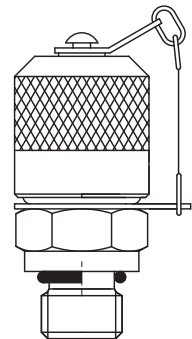

4068H-16X2.0-08

4068H-16X2.0-10

4643

Female MINIMESS® 1620 x
Female NPT

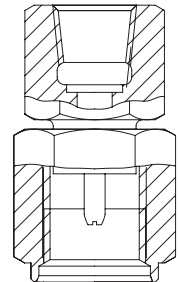

4643-16X2.0-04

MINIMESS® HOSES

Minimess® hoses are microbore hoses that come in the standard lengths of DN2 and DN4. Our large selection of hose materials and fittings will fit almost any configuration. We can source any combination of hose lengths and fitting configurations to suit your needs. Microbore hoses offer excellent flexibility with high working pressure ratings, i.e. 315 bar, 400 bar or 630 bar.

